

[www.airflow-skateboards.com](http://www.airflow-skateboards.com)

# Air Flow

CATALOGUE 2011

Picture: Stefan Kubitschek



# AIRFLOW SKATEBOARDS

Airflow Skateboards thrashing the roadways of Switzerland since 1999! We are known for our cutting edge skateboard development and being a leader in advanced technological design.

Our boards continue to produce victories in both slalom and downhill competitions around the world. We are happy to present an updated lineup of new longboards in 2011 including our latest invention; the Fuse, which features a 3D concave found traditionally in high end composite boards.

In addition to our selective boards, Airflow Skateboards offers team-rider specific, purpose designed promodels (Downhill Promodel Martin Siegrist, Tight Slalom Promodel «The Fox» Ramón Königshausen, S-Shape Promodel Jani Söderhäll, C81 Chris Hart).

Airflow Skateboards continues to stand for performance products that meet the needs of passionate riders.

Whether you are a competitive racer or a relaxed cruiser our boards will bring you back to the roots of skateboarding! Pure passion!

*... feel the flow ...*

Chris Hart  
Airflow Skateboards

*Besten Dank an:  
Puli, Martin, Ramón, Pascal, Roman, Mädi, Marc, Jan, Pia ...!*



Picture: Ramon Königshausen

# AIRFLOW FUSE

On our latest creation you always feel where your feet are; thanks to a unique 3D concave! The precisely molded, tub-like standing platform features slightly conical, 12° raised edges. A 5° footlock keeps your feet on board at any time.

Length:	101 cm
Width:	25 cm
Wheelbase:	77 cm (83 cm)
Rocker:	23 mm
Platform:	67cm
Material:	Beech
Purpose:	Downhill, Freeride



Wood / Red / Black



The «Fuse» is a pure drop through design so far, can be mounted on top of the trucks should the setup be too low. Its low center of gravity provides extra stability and smooth turning on fast hills! The twin tip shape can be rode switch without compromise, and also sideways...

AIRFLOW  
SKATEBOARDS  
**FUSE**



... feel the flow ...





Picture: Loren Guevara

# MARTIN SIEGRIST PROMODEL

This is a pure race board for serious speed! The deck has been developed with **three time IGSA Downhill World Champion Martin Siegrist**. The raised edges (gaspedal) and the big standing platform make for a safe ride, even at high speeds and tight corners.

Length:	103 cm
Width:	25.5 cm
Wheelbase:	78cm (84 cm)
Material:	Birch, Carbon, Fiberglass, Epoxy-Resin
Special:	Drop Through

NEW  
DROPSLOT

Info: Initially the shape was designed for Magun trucks and wheels up to 90mm. The new drop slot works fine for all trucks except old Bears and Crails.

Pure Black



Pure White



**MARTIN SIEGRIST**  
AIRFLOW  
SKATEBOARDS **PRO MODEL**

# AIRFLOW FAST AND FURIOUS

The Fast and Furious is the best of both worlds if you like standard round concave and raised edges. The innovative concave is really aggressive and locks your feet on top of the board when carving hard! The Fast and Furious has a bit of flex and rocker and is THE board for carving and cruising!

<i>Length:</i>	96 cm
<i>Width:</i>	24 cm
<i>Wheelbase:</i>	73.5 cm (79.5cm)
<i>Material:</i>	Ash / Beech, Fiberglass, Epoxy-Resin
<i>Purpose:</i>	Carving, Freeride

The Drop Slot works with all trucks (Paris, Randal R2, Caliber, Bear Grizzly) except Crails.

You'll find the same concave on the Speedwing.

## Wood / Blue





# AIRFLOW PUMP ACTION

No matter if you're pumping through the city or if you're into more action doing tricks and things? The Airflow Pump Action is a very versatile all-round board.

<i>Length:</i>	100 cm
<i>Width:</i>	23.5 cm
<i>Wheelbase:</i>	72.5 cm (78.5 cm)
<i>Material:</i>	Ash / Beech, Fiberglass, Epoxy-Resin
<i>Purpose:</i>	Urban Freeride

The Pump Action features the exact same concave as the Martin Siegrist Promodel. It doesn't have any camber nor rocker which results in a very nice and natural flex. The Pump Action is very comfortable also for long distance pumping.

Thanks to mini-nose and -tail you can also do some tricks.

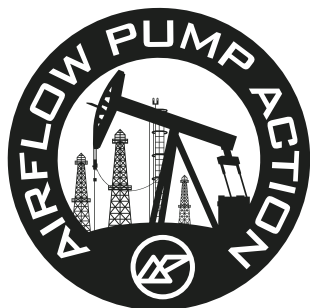

**Wood / Orange / Black**





Picture: Ramon Königshausen

# AIRFLOW SPEED WING CARBON

The 39" Carbon Speedwing is a stiff top mount board designed for speed and hairpins. It features the exact same concave as the Fast and Furious, however the Speedwing is harder and wider.

<i>Length:</i>	99 cm (39")
<i>Width:</i>	25 cm
<i>Wheelbase:</i>	80 cm / 83 cm
<i>Concave:</i>	1.5 cm
<i>Material:</i>	Ash / Beech, Carbon, Fiberglass
<i>Purpose:</i>	Downhill, Freeride



## Carbon





Picture: Ramon Königshausen

# AIRFLOW C81 FOAMCORE

The C81 is a pure race machine designed for GS and Hybridslalom! A cnc machined foamcore, carbon and fiberglass wrapped makes for a superlight yet stiff ride! The deck has no flex and nearly no torsion. Slalom experts can pump faster and much more aggressive compared to a standard deck.

Due to its width, the C81 is a versatile board for nearly any terrain: Proof are countless victories not only in slalom but also boarder cross.

Important information on the C81's concave design:

The C81 features a flat middle and raised edges. This gas-pedal-like profile provides better grip and control especially through turns.

<i>Length:</i>	<i>81cm</i>
<i>Width:</i>	<i>21cm</i>
<i>Wheelbase:</i>	<i>59 / 62 cm</i>
<i>Material:</i>	<i>PU-Foam, Fiber- glass, Epoxy-Resin</i>
<i>Purpose:</i>	<i>Hybrid / GS Boardercross</i>

## AIRFLOW C81

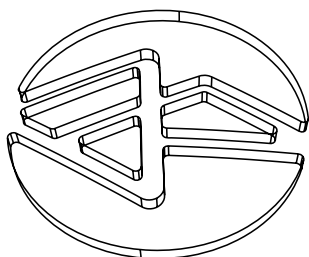





Picture: Michel Terrier

# FOXY PRO MODEL

The Foxy Pro Model is a wide slalom board with a small tail. It takes turns exceptionally well! The board was designed with **Tight Slalom Worldchampion 2006 Ramón "The Fox" Königshausen** and has been proven many many times yet.

Wanna be a slalom champ? Then this is your next board!

Length:	71cm
Width:	21cm
Wheelbase:	62 cm
Material:	Beech, Fiber glass, Resopal, Epoxy-Resin
Purpose:	Urban, Slalom

Blue



Orange



**RAMON**  
AIRFLOW  
SKATEBOARDS  
**PRO KONIGS**  
**MODEL**  
**HAUSEN**

# AIRFLOW FREERIDE LINE 69

A short slalomboard with nice flex, suitable for kids and beginners.  
The 69 goes well with skyhooks.

<i>Length:</i>	69 cm
<i>Width:</i>	17 cm
<i>Wheelbase:</i>	58 cm
<i>Material:</i>	Ash, Fiberglass, Epoxy-Resin
<i>Flex:</i>	XS, S, M, H
<i>Purpose:</i>	Kids, Skyhooks

**Yellow**

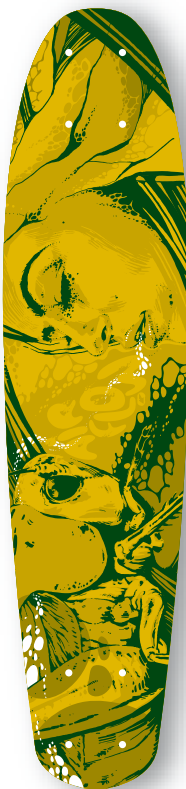

**Blue**

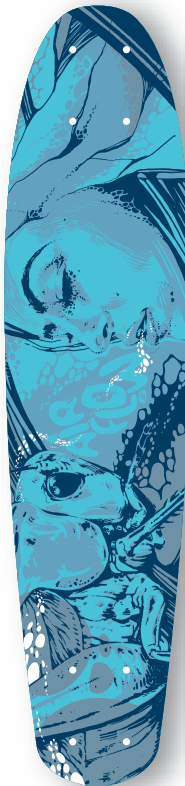



# AIRFLOW FREERIDE LINE 81

A medium and light slalomboard. The 81 has a good platform and makes for a very smooth ride. Goes well with skyhooks for riders above 170 cm.

<i>Length:</i>	81 cm
<i>Width:</i>	19.5 cm
<i>Wheelbase:</i>	64.5 cm
<i>Material:</i>	Ash, Fiberglass, Epoxy-Resin
<i>Flex:</i>	M, H
<i>Purpose:</i>	Urban, Skyhooks

**Yellow**



**Green**





# AIRFLOW FREERIDE LINE 93

The longest board in our freeride line. The 93 has a good platform and makes for a very smooth and stable ride when cruising.

<i>Length:</i>	93 cm
<i>Width:</i>	19.5 cm
<i>Wheelbase:</i>	78.5 cm
<i>Material:</i>	Ash, Fiberglass, Epoxy-Resin
<i>Flex:</i>	M, H
<i>Purpose:</i>	Cruising

**Black / Red**



**Green / Black**



# AIRFLOW RACE LINE 71

A short slalom skateboard for tight turns. Great deck for urban commuting. The raceline decks satisfy both cracks and beginners.

<i>Length:</i>	71 cm
<i>Width:</i>	17.5 cm
<i>Wheelbase:</i>	58.5 cm
<i>Material:</i>	Beech, Fiberglass, Epoxy-Resin
<i>Flex:</i>	XS, S, M, H
<i>Purpose:</i>	Urban, Slalom

About Racegrip: all Raceline decks feature a rough standing platform coated with sand which makes for top friction. It can be cleaned very easily with a brush and a bit of water.

The Airflow Raceline decks are the only boards with a design on the top side.

**Top (Racegrip)**

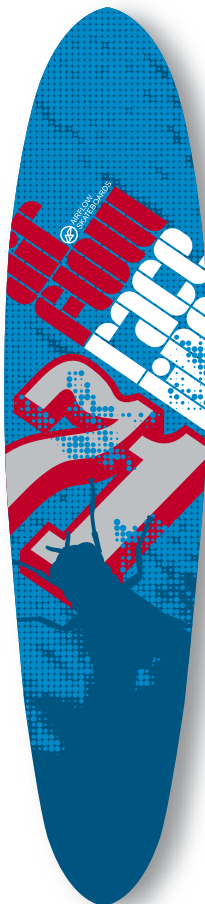

**Bottom**



Flex selector:

XXS	- 30 kg
XS	30 - 50 kg
S	45 - 65 kg
M	60 - 80 kg
H	75 - 90 kg

# AIRFLOW RACE LINE 71

Blue / Red



Green / Yellow



Black / Red



# JANI SÖDERHÄLL S-CAMBER

In the 80ies already the S-Camber has been built in Switzerland for slalom legend Heini Temperli. The Airflow S-Camber has been fully redesigned for teamrider **Jani Söderhäll**. The S-Camber is a rather short slalom board and features a slight concave, even on the tail. Its preferred terrain is tight slalom. The S-Camber works really well for urban freeride and commuting.

Length:	71 cm
Width:	21 cm
Wheelbase:	59 / 62 cm
Material:	Ash / Beech, Fiberglass, Epoxy-Resin
Purpose:	Urban, Slalom

Grey / Orange



Grey / Blue



# JANI SÖDERHÄLL S-CAMBER XL

The S-Camber XL is identical to the regular S-Camber, however without cutout for a wider standing platform.

Length:	71 cm
Width:	21 cm
Wheelbase:	59 / 62 cm
Material:	Ash / Beech, Fiberglass, Epoxy-Resin
Purpose:	Urban, Slalom

Grey / Orange



Grey / Blue





# AIRFLOW WHEELS

Wheels are the link in between skateboard / trucks and the asphalt: They affect speed, steering, dampening and grip. Airflow Skateboards offers a good choice of standard wheels designed for daily use.

## Airflow Cruiser Orange

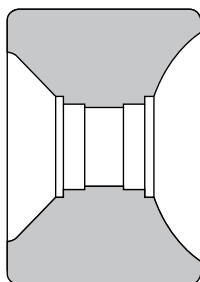

Diameter: 70 mm  
Durometer: 78a  
Color: opac orange  
Purpose: good allround wheels

## Airflow Cruiser Black

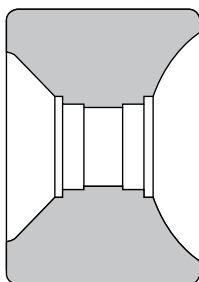

Diameter: 70 mm  
Durometer: 78a  
Color: black  
Purpose: good allround wheels

## Airflow Hawaii

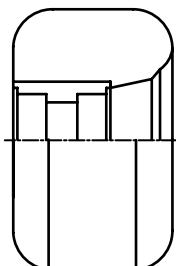
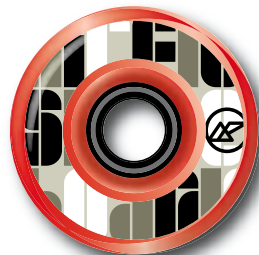

Diameter: 65 mm  
Durometer: 78a  
Color: red  
Purpose: good allround and slide wheels

# AIRFLOW ACCESSORIES

## Airflow Skyhooks ALU



Skyhooks enable jumps on a slalomboard; angle adjustable.

Color: black, blue, red, orange, alu raw

## Airflow Riser Pads



Changes height and turning of trucks.

Angle: 12°

## Airflow Griptape



Airflow Barbapapa graphics

Color: assorted  
Size: 26 x 22.8 cm

## ... for a better flow ...

Airflow Bearings:

Steel ABEC-7

8 pieces incl. 10 mm spacer

Airflow Liquid Speed:

Synthetic Bearing Oil, 10 ml

Developed with Elf Lubricants!



# TRUCKS

## AIRFLOW OFFSET TRUCK

The Airflow Offset Truck has been designed especially for slalom racing and is by far the most common rear truck in competition! The geometry decreases rear steering and thus enables faster and more direct turning around cones. True 8 mm axles make for a perfect bearing fit.

Attention: The golden spacers must be used on the outside of bearings, right before the nut!

<i>Width:</i>	<i>110 mm</i>
<i>Color:</i>	<i>Anthrazite, Gold</i>
<i>Purpose:</i>	<i>rear truck for slalom racing</i>

**Airflow Offset Truck**



## TRACKER RTX / RTS

Racetruck X (turny) and Racetruck S (stable) are the redesigned, slalom optimized version of the legendary B2's. The RTX is generally used as front truck whereas the stable RTS serves as rear truck. We suggest 129mm RTS for longer slalom boards.

<i>Width:</i>	<i>110 mm/129 mm</i>
<i>Color:</i>	<i>raw</i>
<i>Purpose:</i>	<i>freeride / racing</i>
	<i>RTX (front)</i>
	<i>RTS (rear)</i>

**Tracker RTX / RTS**



# AIRFLOW SKATEBOARDS

## Production / Development

Chris Hart  
Hermetschloostr. 70  
8048 Zürich

phone +41 (0)44 430 57 07  
fax +41 (0)44 430 57 08

chris@airflow-skateboards.com  
www.airflow-skateboards.com

## Distribution Switzerland

Mavericks Distribution GmbH  
Althartstrasse 147  
8105 Regensdorf

phone + 41 (0)43 388 86 93  
fax + 41 (0)43 388 86 94

info@mavericks-dist.com

## Dist. Europe (except Germany)

Surf2Go  
Sumatrastraat 267  
2585 CR The Hague  
Netherlands

phone +31 (70)3316182  
phone +31 (70)2500246  
cell +31 (6)41725725

info@surf2go.nl  
www.surf2go.eu

## Distribution Germany

Season Distribution  
Heiko Schöller  
Venloerstrasse 502  
50825 Köln

phone +49 (0)221 2053641  
fax +49 (0)221 3108396

info@seasondistribution.de  
www.seasondistribution.de